

TAPPED - FULL BASE

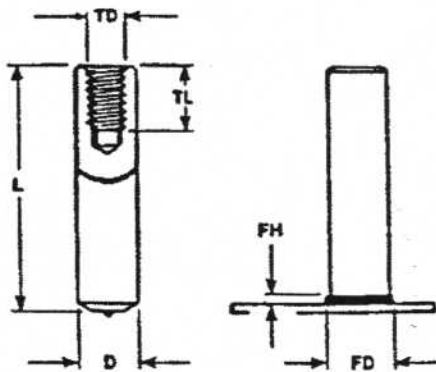

STUD						
D	MIN L	TD	TL*	MAX FD	MAX FH	FERRULE CODE
1/4	9/16	8-32	1/4	.359	.109	F250
5/16	21/32	10-24	9/32	.437	.109	F312
3/8	13/16	1/4-20	3/8	.500	.125	F375
7/16	29/32	5/16-18	15/32	.578	.140	F437
1/2	1-1/32	3/8-16	9/16	.625	.156	F500
5/8	1-9/32	3/8-16	9/16	.625	.156	F500
3/4	1-3/8	1/2-13	3/4	.937	.250	F750
7/8	1-5/8	5/8-11	15/16	1.093	.312	F875

* Maximum standard tap depth equals 1-1/2 times tap diameter.

TAPS: Standard tap is UNC-2B, other taps are available.

MATERIAL: LOW CARBON STEEL
 C-0.23% max. P-0.04% max.
 Mn-0.90% max. S-0.05% max.

STAINLESS STEEL
 AISI grade - 302/304/305 std.
 Other grades available upon request.

MECHANICAL PROPERTIES:
 Tensile 60,000 psi (min.)
 Yield 50,000 psi (min.)
 Elongation 20% (in 2 inches)

Values for various grades available upon request.

PLATING: Plating is not standard. Cadmium, copper nickel, and zinc available upon customer request.

Does not apply to Stainless.

FERRULES: Ferrules are component parts of studs. Not sold separately.

FERRULE

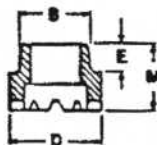

CODE	B	D	E	M	PART NO.
F250	.380	.455	.156	.390	092 0005 06
F312	.445	.578	.156	.390	092 0005 07
F375	.505	.640	.156	.390	092 0005 08
F437	.585	.703	.188	.422	092 0005 09
F500	.650	.795	.188	.438	092 0005 10
F625	.785	1.030	.188	.516	092 0005 11
F750	1.030	1.218	.188	.656	092 0005 12
F875	1.203	1.406	.188	.732	092 0005 13

TO ORDER OR SPECIFY GIVE:

1. Product Code ARC TAPFB
2. Diameter D
3. Length L
4. Tap Diameter TD
5. Tap Length TL
6. Material



Studwelding Equipment, Fasteners & Supplies
 Boiler Outage Specialists
 Jobsite Studwelding Division
 P.O. Box 5658, Deptford, NJ 08096
 Phone: (856) 218-8301
 Fax: (856) 218-8305
 Toll Free: (888) 889-3833
 steve@newagestudwelding.com

All information contained herein subject to change without notice.