

RECTANGULAR- 'T' SLOTTED

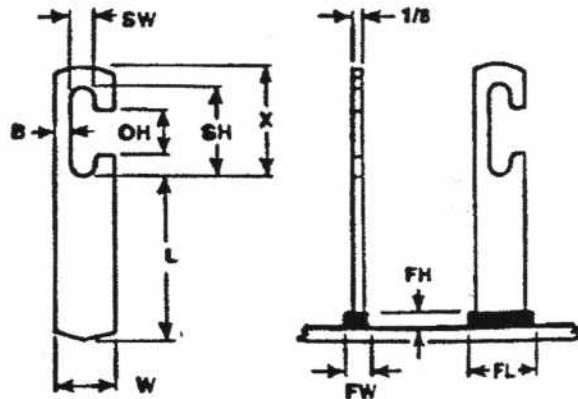

STUD					
W	MIN L	OH	SH	X	SW
3/8	1/2	.322	.531	.765	.130
5/8	1/2	.500	1.000	1.250	.255

STUD (CONTINUED)				
B	FW	FL	FH	FERRULE CODE
.122	.218	.437	.125	R375
.185	.218	.687	.156	R625

MATERIAL: LOW CARBON STEEL C - 0.23% max. P - 0.04% max. Mn - 0.90% max. S - 0.05% max.	STAINLESS STEEL AISI grade - 302/304/305 std. Other grades available upon request.
MECHANICAL PROPERTIES: Tensile 60,000 psi (min.) Yield 50,000 psi (min.) Elongation 20% (in 2 inches)	Values for various grades available upon request.
PLATING: Plating is not standard. Cadmium, Copper, Nickel, and Zinc available upon customer request.	Does not apply to Stainless.

FERRULES: Ferrules are component parts of studs. Not sold separately.

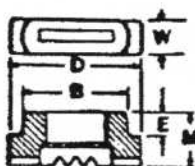

FERRULE					
CODE	B	D	E	M	PART NO.
R375	.505	.625	.156	.390	092 0020 08
R625	.921	1.093	.188	.438	092 0020 11

TO ORDER OR SPECIFY GIVE:

1. Product Code ARC R-TS
2. Size 1/8 x W
3. Length L
4. Material

NEW-AGE
FASTENING SYSTEMS, INC.

Studwelding Equipment, Fasteners & Supplies
Boiler Outage Specialists
Jobsite Studwelding Division
P.O. Box 5658, Deptford, NJ 08096
Phone: (856) 218-8301
Fax: (856) 218-8305
Toll Free: (888) 889-3833
steve@newagestudwelding.com

All information contained herein subject to change without notice.