

SHORT REDUCED BASE

STUD						
D	MIN L	MIN BD	MIN BL	FD	FH	FERRULE CODE
1/4	7/8	.187	.156	.281	.109	TB250
5/16	7/8	.275	.250	.390	.109	RB312
3/8	7/8	.312	.250	.437	.125	RB375
1/2	1	.435	.250	.593	.156	RB500
5/8	1-1/8	.500	.312	.687	.156	TB625
3/4	1-1/8	.625	.375	.812	.187	TB750

THREADS: Standard thread is UNC-2A (Rolled when possible), other threads are available upon request. Maximum standard thread length is 3-7/8".

MATERIAL:	LOW CARBON STEEL	STAINLESS STEEL
	C-0.23% max. P-0.04% max. Mn-0.90% max. S-0.05% max.	AISI grade - 302/304/305 std. Other grades available upon request.

MECHANICAL PROPERTIES:	Tensile 60,000 psi (min.)	Values for various grades available upon request.
	Yield 50,000 psi (min.)	
Elongation 20% (in 2 inches)		

PLATING: Plating is not standard. Cadmium, copper nickel, and zinc available upon customer request.	Does not apply to Stainless.
--	------------------------------

FERRULES: Ferrules are component parts of studs. Not sold separately.

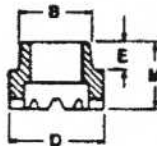

FERRULE					
CODE	B	D	E	M	PART NO.
TB250	.380	.455	.156	.375	092 0012 06
RB312	.445	.546	.156	.437	092 0012 07
RB375	.505	.640	.156	.437	092 0012 08
RB500	.650	.796	.187	.468	092 0012 10
TB625	.785	1.030	.187	.578	092 0012 11
TB750	.921	1.140	.203	.593	092 0012 12

TO ORDER OR SPECIFY GIVE:

1. Product Code ARC SRB
2. Diameter D
3. Length L
4. Material



Studwelding Equipment, Fasteners & Supplies
 Boiler Outage Specialists
 Jobsite Studwelding Division
 P.O. Box 5658, Deptford, NJ 08096
 Phone: (856) 218-8301
 Fax: (856) 218-8305
 Toll Free: (888) 889-3833
 steve@newagestudwelding.com