

TAPPED - REDUCED BASE

STUD						
D	MIN L	TD	TL*	BD	BL	FERRULE CODE
3/8	1-1/2	1/4-20	3/8	.250	7/16	FS250
1/2	1-1/2	3/8-16	9/16	.375	7/16	FS375
5/8	1-1/2	7/16-14	21/32	.500	1/2	FS500
3/4	1-1/2	7/16-14	21/32	.500	1/2	FS500
7/8	2	5/8-11	15/16	.625	5/8	FS625
1"	2-1/2	3/4-10	1"	.750	5/8	FS750

* Maximum standard tap depth equals 1-1/2 times tap diameter.

TAPS: Standard tap is UNC-2B, other taps are available.

MATERIAL: LOW CARBON STEEL
 C-0.23% max. P - 0.04% max.
 Mn - 0.90% max. S - 0.05% max.

STAINLESS STEEL
 AISI grade - 302/304/305 std.
 Other grades available upon request.

MECHANICAL PROPERTIES:
 Tensile 60,000 psi (min.)
 Yield 50,000 psi (min.)
 Elongation 20% (in 2 inches)

Values for various grades available upon request.

PLATING: Plating is not standard. Cadmium, copper nickel, and zinc available upon customer request.

Does not apply to Stainless.

FERRULES: Ferrules are component parts of studs. Not sold separately.

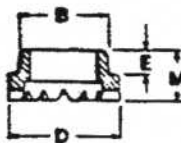

FERRULE					
CODE	B	D	E	M	PART NO.
FS250	.380	.455	.125	.250	092 0005 06
FS375	.585	.675	.125	.250	092 0005 08
FS500	.785	.875	.156	.281	092 0005 10
FS625	.921	1.030	.187	.375	092 0005 11
FS750	1.043	1.203	.187	.375	092 0005 12

TO ORDER OR SPECIFY GIVE:

1. Product Code ARC TAPRB
2. Base Diameter BD
3. Base Length BL
4. Thread Diameter TD
5. Thread Length TL
6. Material

NEW-AGE
FASTENING SYSTEMS, INC.

Studwelding Equipment, Fasteners & Supplies
 Boiler Outage Specialists
 Jobsite Studwelding Division
 P.O. Box 5658, Deptford, NJ 08096
 Phone: (856) 218-8301
 Fax: (856) 218-8305
 Toll Free: (888) 889-3833
 steve@newagestudwelding.com

All information contained herein subject to change without notice.